

FISHEYE CAMERA

12 MP resolution and AI-based analytics

Securely access this cloud-managed camera from anywhere and from any device. It features onboard analytics and built-in IR. And you can take advantage of new features via automatic updates.



360° COVERAGE

Get complete situational awareness of an entire area—in 12 MP resolution—with unlimited viewing angles and no blind spots, from just one camera.



OBSERVE MULTIPLE ANGLES

Digital PTZ lets you see high-quality video from multiple angles simultaneously. Plus, the full field-of-view is always recorded so you can go back to look at different areas at any time.



HOT SPOT PREFERENCES

The camera's flexible display modes let you set up preferred viewing angles to target your specific areas of interest so they're always prominently displayed.



SEE IN THE DARK

Thanks to the camera's integrated IR, you'll get high-quality video—even in total darkness—from up to 49 ft (15 m) away.



DIMINISH NUISANCE ALARMS

The camera can detect motion triggered by a person and/or vehicle vs. motion triggered by things like blowing leaves, so you can respond to genuine threats quicker.



FASTER INVESTIGATIONS

Object-based motion detection lets you filter out non-relevant video for faster incident resolution, and also reduces storage requirements.



THIS INTELLIGENT PANORAMIC CAMERA OFFERS A NUMBER OF ADVANTAGES



Tamper-proof and weather-resistant components protect the camera from vandalism and harsh temperatures and environments



Integrated microphone lets you hear what's happening in the scene for additional intel



Starlight low-light imaging provides color images in dark scenes



Wide Dynamic Range helps counteract challenging lighting conditions like reflective glare and backlighting

Featuring onboard storage and bandwidth-friendly smart encoding, this dome requires just a single Ethernet PoE connection to operate. Additionally, our PoE Port Combiner/Splitter lets you co-locate a second camera on that same PoE drop, making it easier and more cost effective to add additional coverage for high-risk areas.

HERE'S HOW IT COMES TOGETHER

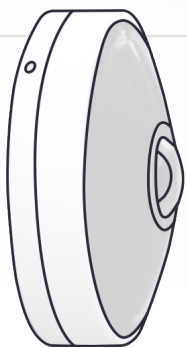

Ethernet

Install your camera and plug it into a PoE switch to power it up.

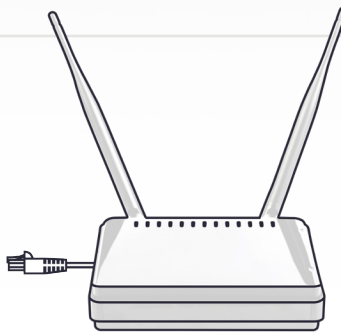

Connect the PoE switch to your router so you can access your camera via the cloud.



Your new camera is up and running and you'll see it in your Anavio portal.

MOUNTING OPTIONS

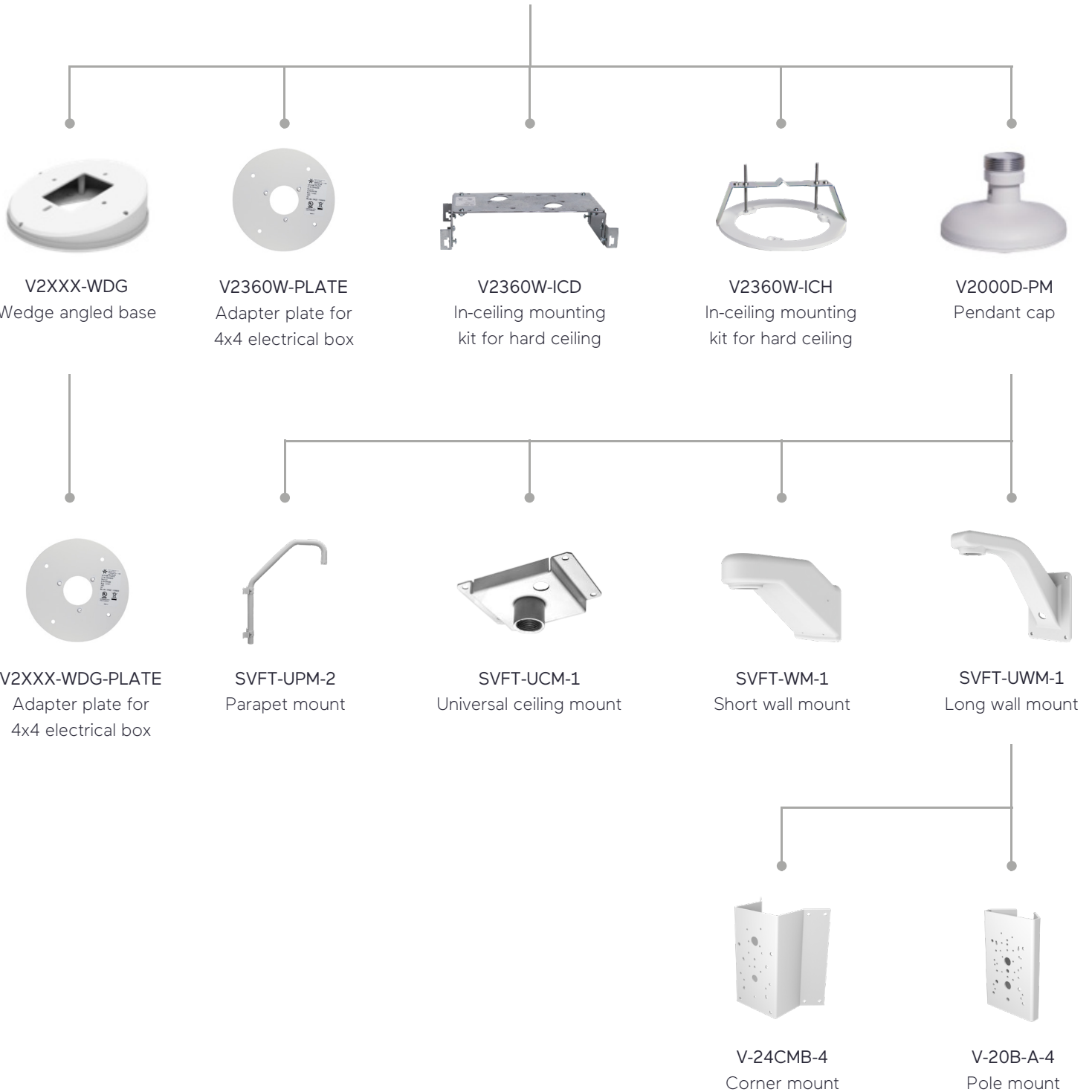

SPECIFICATIONS

CAMERA

Image Sensor
1/2.3 in.

Max Resolution
2976x2976 (12 MP)

Image Settings
Flip, mirror

AI-Based Object Classification Analytics
Vehicles, people, animals

Electronic Shutter Speed
Auto (1/2 ~ 1/10,000 sec)

Day/Night Performance
True day/night (IR cut filter)

Wide Dynamic Range
True WDR; 120 dB

Minimum Illumination (@ 30 IRE)
Color:
0.007 lux

BW:
IR Off: 0.1 lux
IR On: 0 lux

IR Distance
Smart IR
49 ft (15 m)

LENSES

Focal Length
1.6 mm

Max. Aperture
f/2.0

Iris
Fixed

Zoom/Focus Adjust
Fixed

Field-of-View
Full Resolution: 195°
Surround View: 360°

VIDEO TRANSMISSION

Network
10/100Base-T/TX: RJ-45

Image Compression
H.264; H.265; M-JPEG

Resolution
High Quality: 2976x2976 (3000 Kbps)
Standard Quality: 960x960 (600 Kbps)

Frame Rate
24 fps

Alarm
1 alarm input/1 alarm output

Audio
1 audio input/1 audio output;
built-in mic

MECHANICAL

Construction
Enclosure: White aluminum
Dome bubble: Polycarbonate

Dimensions (HxD)
2.2 x 5.0 in.
(57 x 150 mm)

Weight
2 lb (0.9 kg)

ELECTRICAL

Input Power
PoE+ IEEE 802.3at class 4;
24 VAC (+20%/-10%)

Current (IR On)
PoE: 0.52 A; 24 VAC: 1.1 A

Power Consumption
IR and Heaters On: 13.9 W
IR Off and Heaters On: 10.7 W
IR and Heaters Off: 8.3 W

SPECIFICATIONS

ENVIRONMENTAL

Dual Heater System

For low temperature operation:
Heater turns on at -40° F (-40° C)
and off at 59° F (15° C)

For defog operation:

Heater turns on at -40° F (-40° C)
and off at 140° F (60° C)

Operating Conditions

-40° to 122° F (-40° to 50° C)

Humidity

Up to 90%, non-condensing

CONTROLS + CONNECTORS

Connectors

Internal cable termination; optional
conduit backbox

Power

24 VAC: terminal block

PoE/Network

RJ-45 CAT5

Alarm

Terminal block

Audio

Built-in mic and terminal block

Micro SD card slot

SDHC/SDXC card (1 TB, included)

REGULATORY

Approvals

UL, FCC Class A, CE, IP67,
IK10, RoHS

Certifications

NDAA, GSA, TAA

Country of Origin

Taiwan



ORDERING INFORMATION

CAMERA

VA-DFE12A-1TB
12 MP Fisheye Camera with
1 TB storage

CAMERA CONNECTION LICENSES

VA-CLIC1Y
1-Year Camera License

VA-CLIC3Y
3-Year Camera License

VA-CLIC5Y
5-Year Camera License

VA-CLIC10Y
10-Year Camera License

ACCESSORIES

V-POE-CS2
Combiner/Splitter for co-locating
any two Anavio cameras

V-POC-1KIT
PoE-to-Coax converter (single-channel)

V-POC-4KIT
PoE-to-Coax converter (4-channel)

V-POC-8KIT
PoE-to-Coax converter (8-channel)

V-POC-RMP
Rack mount unit for 100W/240W
power supply

V-POC-RM4
Rack mount unit for Base 4
or Base 8 units

Please contact your Vicon sales representative for more information.



Vicon Data Sheet Number: 8009-7339-00-00

Specifications subject to change without notice.
Vicon and their logos are registered trademarks of Vicon Industries Inc.
Copyright © 2023 Vicon Industries Inc. All rights reserved.

