

Quick Install Guide

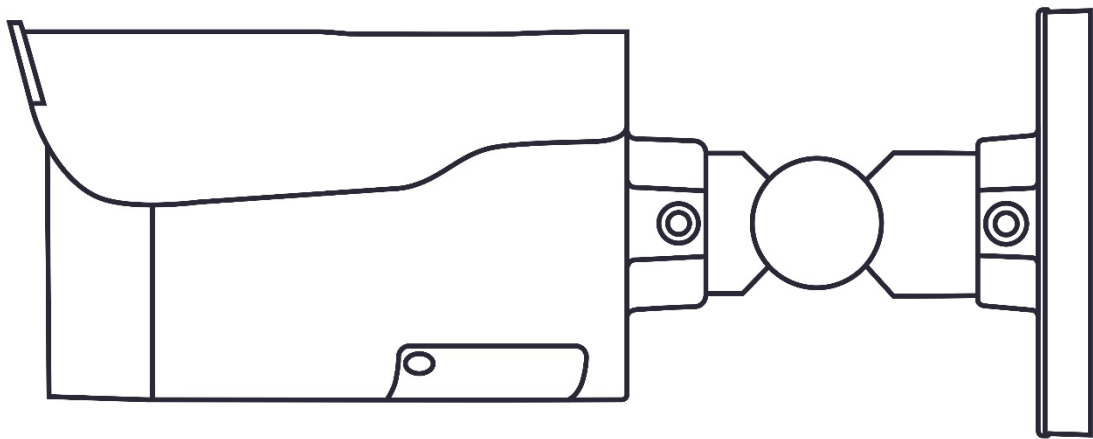



ANAVIO Bullet Camera

VA-BVF08A-1TB



WARNING

- This camera operates at 12 VDC/24 VAC/PoE+ (IEEE 802.3at Class 4).
- Installation and service should be performed only by qualified and experienced technicians and comply with all local codes and rules to maintain your warranty.
- We are NOT liable for any damage arising either directly or indirectly from inappropriate installation which is not depicted within this documentation.
- To reduce the risk of fire or electric shock, do not expose the product to rain or moisture.
- Wipe the camera with a dry soft cloth. For tough stains, slightly apply a diluted neutral detergent and wipe with a dry soft cloth.
- Do not apply benzene or thinner to the camera, which may cause the surface to melt or lens to fog.
- Avoid aligning the lens with extremely bright objects (e.g., light fixtures) for long periods of time.
- Although this camera is waterproof and suitable for both indoor and outdoor usages, please do not immerse the camera into water.
- Avoid operating or storing the camera in the following locations:
 - Extremely humid, dusty, or hot/cold environments (recommended operating temperature: -40 to 140° F/-40°C to +60°C)
 - Close to sources of powerful radio or TV transmitters
 - Close to fluorescent lamps or objects with reflections
 - Under unstable or flickering light sources

	CAUTION RISK OF ELECTRIC SHOCK DO NOT OPEN			THIS SYMBOL INDICATES THAT DANGEROUS VOLTAGE CONSTITUTING A RISK OF ELECTRIC SHOCK IS PRESENT WITHIN THE UNIT.
CAUTION: TO REDUCE THE RISK OF ELECTRIC SHOCK, DO NOT REMOVE THE COVER. NO USER-SERVICEABLE PARTS INSIDE. REFER SERVICING TO QUALIFIED SERVICE PERSONNEL.			THIS SYMBOL INDICATES THAT IMPORTANT OPERATING AND MAINTENANCE INSTRUCTIONS ACCOMPANY THIS UNIT.	



WEEE (Waste Electrical and Electronic Equipment). Correct disposal of this product (applicable in the European Union and other European countries with separate collection systems). This product should be disposed of, at the end of its useful life, as per applicable local laws, regulations, and procedures.

FCC COMPLIANCE STATEMENT

Information to the user: This unit has been tested and found to comply with the limits for a Class A digital device pursuant to Part 15 of the FCC Rules. Operation is subject to the following two conditions: (1) this device may not cause harmful interference, and (2) this device must accept any interference received, including interference that may cause undesired operation. These limits are designed to provide reasonable protection against harmful interference in a residential installation. This unit generates, uses, and can radiate radio frequency energy and, if not installed and used in accordance with the manual, may cause harmful interference to radio communications. However, there is no guarantee that interference will not occur in a particular installation.

If this unit does cause harmful interference to radio or television reception, which can be determined by turning the unit off and on, the user is encouraged to try to correct the interference by one or more of the following measures:

- Reorient or relocate the receiving antenna.
- Increase the separation between the unit and receiver.
- Connect the unit to an outlet on a circuit different from that to which the receiver is connected.
- Consult the dealer or an experienced radio/TV technician for help.

CAUTION Changes or modifications not expressly approved by the party responsible for compliance could void the user's authority to operate the unit.

CE STATEMENT

Operation is subject to the following two conditions: (1) this device may not cause harmful interference, and (2) this device must accept any interference received, including interference that may cause undesired operation. The manufacturer declares that the unit supplied with this guide is compliant with the essential protection requirements of EMC directive and General Product Safety Directive (GPSD) conforming to requirements of standards EN 55022 for emission and EN 50130-4 for immunity.

This product is IP67 rated for outdoor environments and IK10 rated for impact protection. The camera also meets regulations required to be NDAA, GSA schedule and TAA approved.

TABLE OF CONTENTS

1. PRODUCT OVERVIEW	4
<hr/>	
PHYSICAL CHARACTERISTICS	4
2. INSTALLATION AND MOUNTING	7
<hr/>	
PACKAGE CONTENTS	7
INSTALLATION	7
CHECKING APPEARANCE	7
MOUNTING THE CAMERA	8
CONNECTING THE CABLES	8
WATERPROOF ETHERNET CONNECTOR WIRING	9
ADJUSTING THE CAMERA POSITION	11
ADJUSTING THE SUNSHIELD	12

1. PRODUCT OVERVIEW

PHYSICAL CHARACTERISTICS

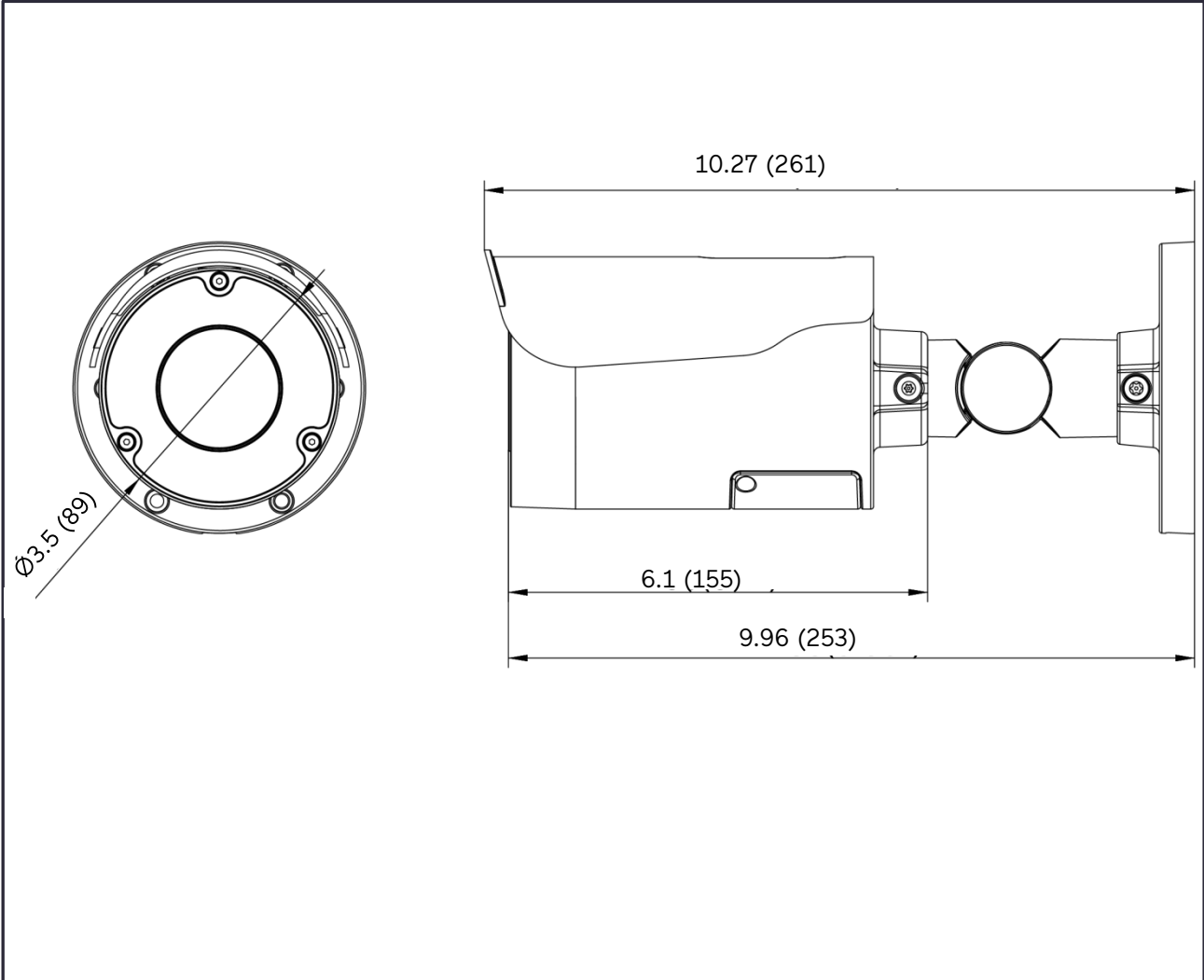

FIGURE 1-1: PHYSICAL DIMENSIONS [IN. (MM)]

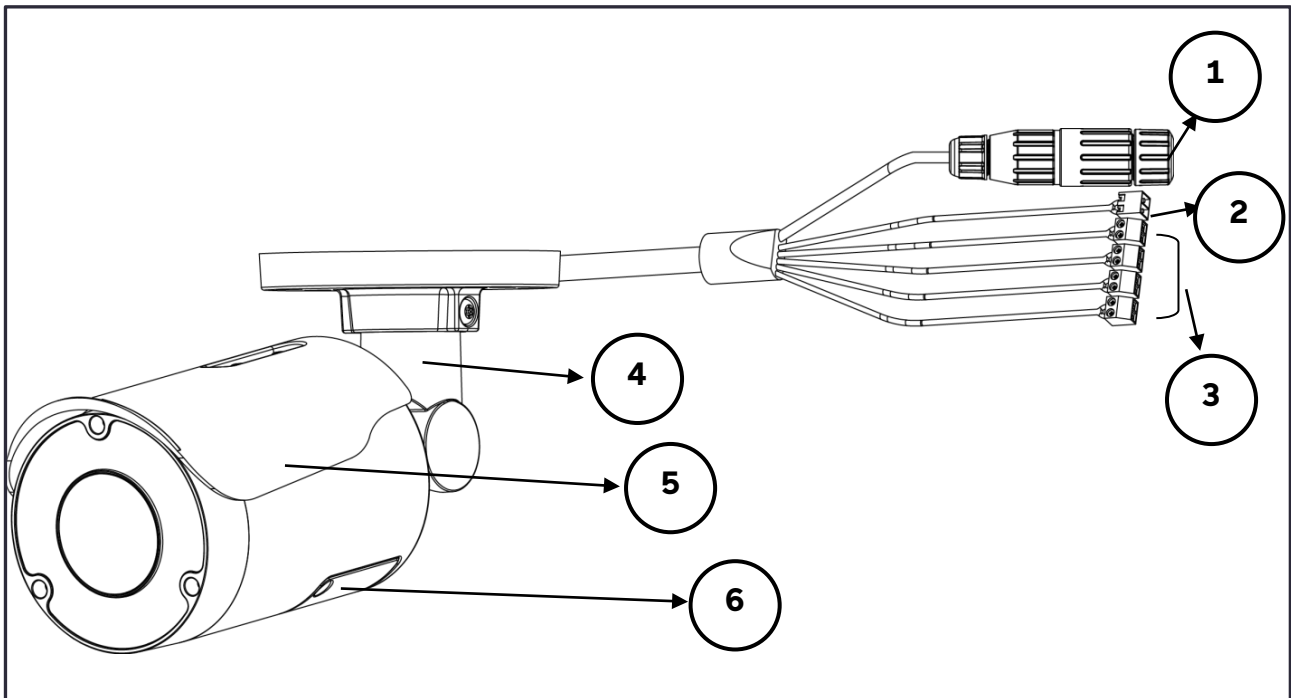

FIGURE 1-2: CAMERA COMPONENTS

1 RJ-45 Ethernet/PoE Port

Connect an Ethernet cable terminated with RJ-45 connector to the PoE RJ-45 port for both power supply and network connectivity.

- Audio In: Via "+" and "Ⓐ" ports; connect to external device, such as microphone, that receives sound.
- Audio Out: Via "+" and "Ⓐ" ports; connect to device, such as speaker, to transmit sound.

2 12 VDC or 24 VAC Port

Power the camera via 12 VDC or 24 VAC power source. Pay attention to the polarities when connecting 12 VDC power supply. Refer to Wiring table.

Wire Color	Function
Red	12 VDC (+)/24 VAC (-)
Black	12 VDC (-)/24 VAC (-)
Purple	Audio Out (+)
Green	Audio Out (-)
Yellow	Audio In (+)
Orange	Audio In (-)
Brown	Alarm Out (Signal)
Blue	Alarm Out (COM)
Red	Alarm In (Signal)
Black	Alarm In (GND)

3 Alarm/Audio Inputs and Outputs

DI/DO (Digital Input/Digital Output) ports are provided for external devices, e.g., door contacts, smoke detector, audible alarm, etc. Refer to Wiring table.

- Alarm In: Via "AI" and "GND" ports; connect to external device that can trigger alarm input signals.
- Alarm Out: Via "AO" and "COM" ports; connect to external device to be triggered through alarm output signals.

Audio Input/Output ports are provided for connection of external microphone and speaker.

4 Mounting Bracket

Mount the camera onto a surface. The mounting bracket has 3 axes adjustment.

5 Sunshield

For minimizing the effects from rain and sunlight on image quality.

6 Access Cover

Houses the RESET/DEFAULT button, Micro SD Card Slot, etc.

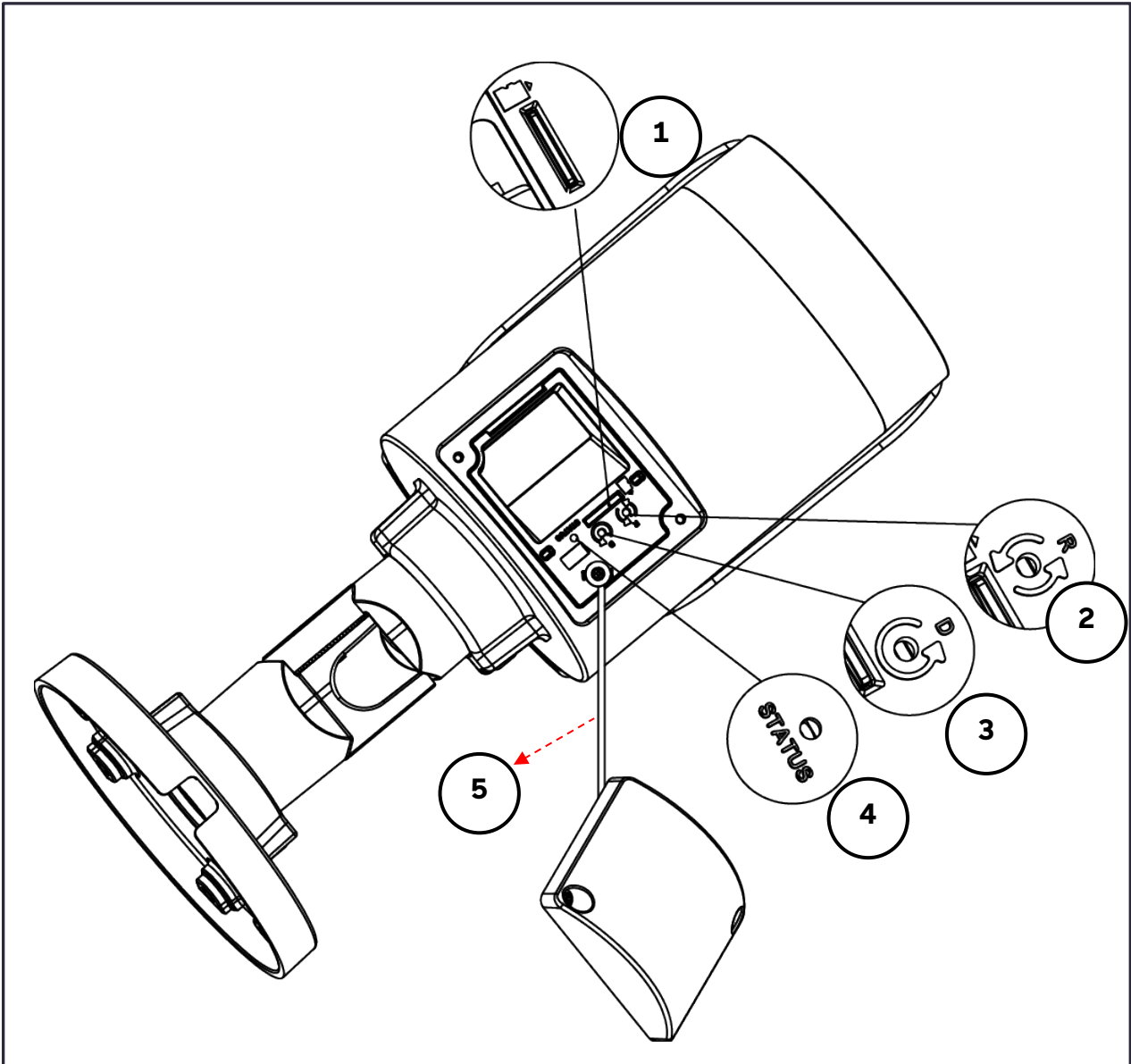

FIGURE 1-3: CAMERA INTERFACES

1

Micro SD Card Slot

Micro-SD card (1 TB, included) slot for recording and file storage.

2

Reset Button

Press the button for 1 second to reboot the camera.

3

Default Button

Press the button for 6 seconds to restore the camera settings to factory default.

4

Status LEDs

Solid Red: Indicates boot up is running. After 2-3 seconds:

- Solid Red to Flashing Green if boot up is normal.
- Remains Solid Red if an error occurs.
- Turns off 3 minutes after a successful boot.

Flashing Amber: Indicates firmware upgrade is running.

5

Safety Lanyard

The safety lanyard is used to secure the access cover. When installing the cover, be sure the lanyard does not get pinched between the cover and gasket, to ensure the camera remains watertight.

2. INSTALLATION AND MOUNTING

PACKAGE CONTENTS

Ensure all items listed below are included in the packing box.

- Bullet Camera (Qty 1)
- Plastic Anchor (Qty 6)
- Self-Tapping Screw (T10) (Qty 6)
- T10 Security Torx Bit (Qty 1)
- RJ-45 Waterproof Connector Kit (Qty 1; preinstalled)
- Mounting Template (Qty 1)

INSTALLATION

The following tools might be helpful for completing the installation:

- Drill
- Screwdrivers
- Wire cutters

CHECKING APPEARANCE

When unpacking, check to see if there is any visible damage to the appearance of the camera and its accessories. Remove the protective materials from the camera after every item is properly checked in accordance with the list in **PACKAGE CONTENTS**.

PREPARING THE MOUNTING SURFACE

1. Place the supplied mounting template on a mounting surface.
2. Drill 6 mm (0.25") outer holes (x6) at the mounting surface corresponding to the 6 indicated positions for plastic anchors.
3. Insert and hammer the plastic anchors into the drilled holes.

CONNECTING THE CABLES

1. Based on your needs, connect the power cable to the power port via one of the following 3 options.
 - **24 VAC:** Connect a power cable that supplies 24 VAC power source to the terminal block and then insert the terminal block into the power port.
 - **12 VDC:** Connect a power cable that supplies 12 VDC power source to the terminal block and then insert the terminal block into the power port.

NOTE: Be sure the polarities match when using 12 VDC power source.

 - **PoE (Class 4):** Connect an Ethernet cable terminated with an RJ-45 connector to the PoE RJ-45 port for both power supply and network connectivity.
2. Connect audio in/out cables and alarm in/out cables to the corresponding terminals of the camera if required.

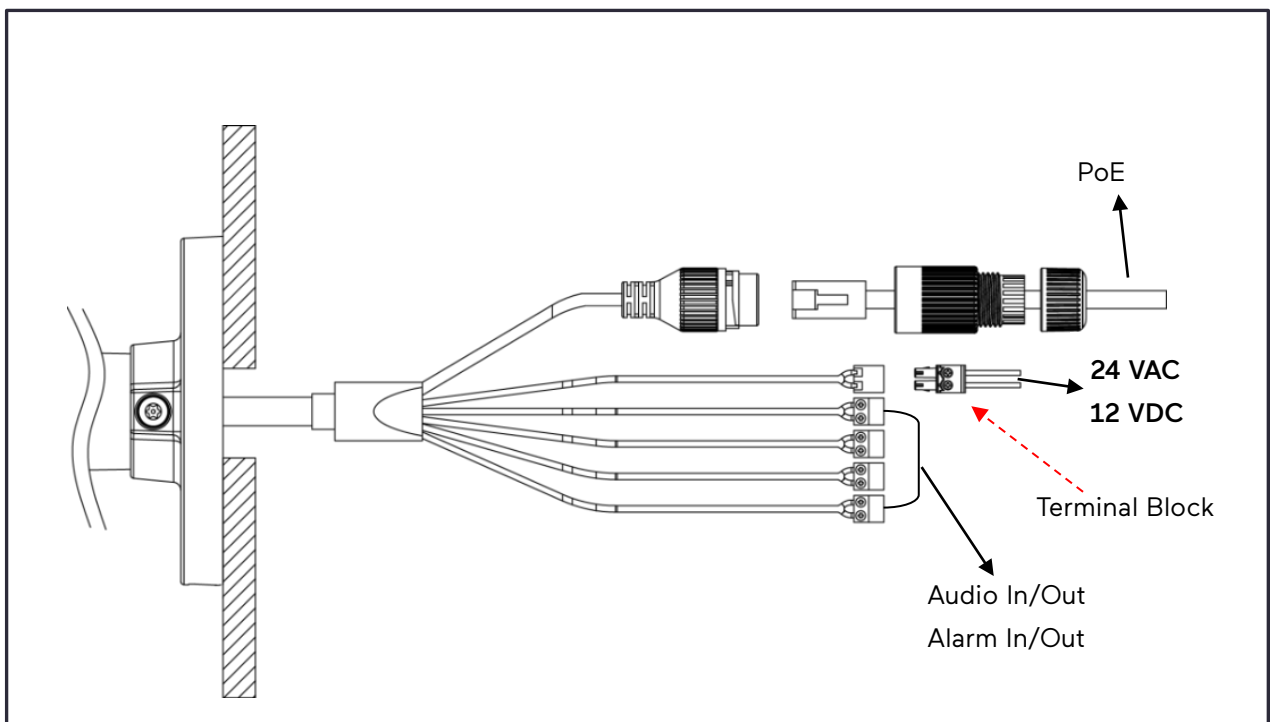
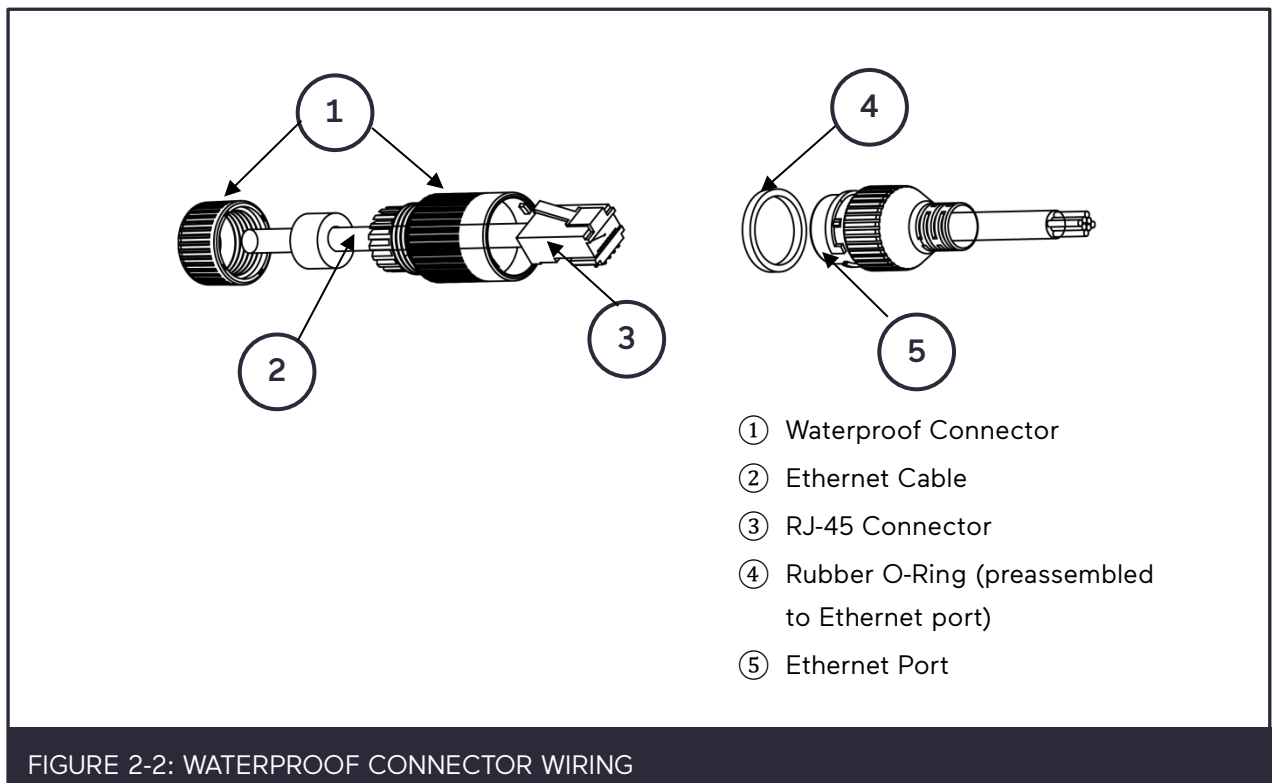

FIGURE 2-1: CONNECTING THE CABLES

WATERPROOF ETHERNET CONNECTOR WIRING

1. Pass the Ethernet cable through the waterproof connector and terminate the cable with RJ-45 connector.
2. Plug the RJ-45 connector into the female Ethernet port for network connection.
3. Assemble the waterproof connector to the Ethernet port tightly for ingress protection.



4. Pass all cables that exit from the mounting bracket through the hole in the mounting surface.

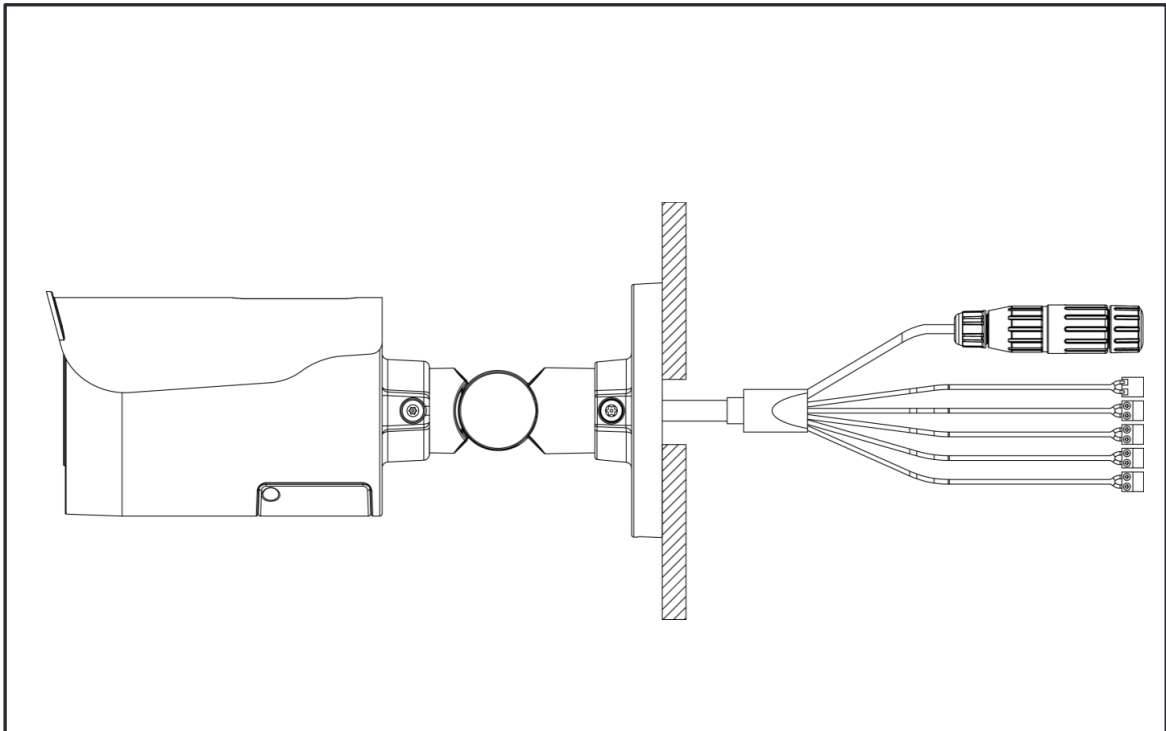

FIGURE 2-3: ROUTING THE WIRES

5. As shown in Figure 2-4, align the camera with the 6 holes previously drilled.
6. Install the camera to the mounting surface by tightly securing the 6 self-tapping screws into the plastic anchors.

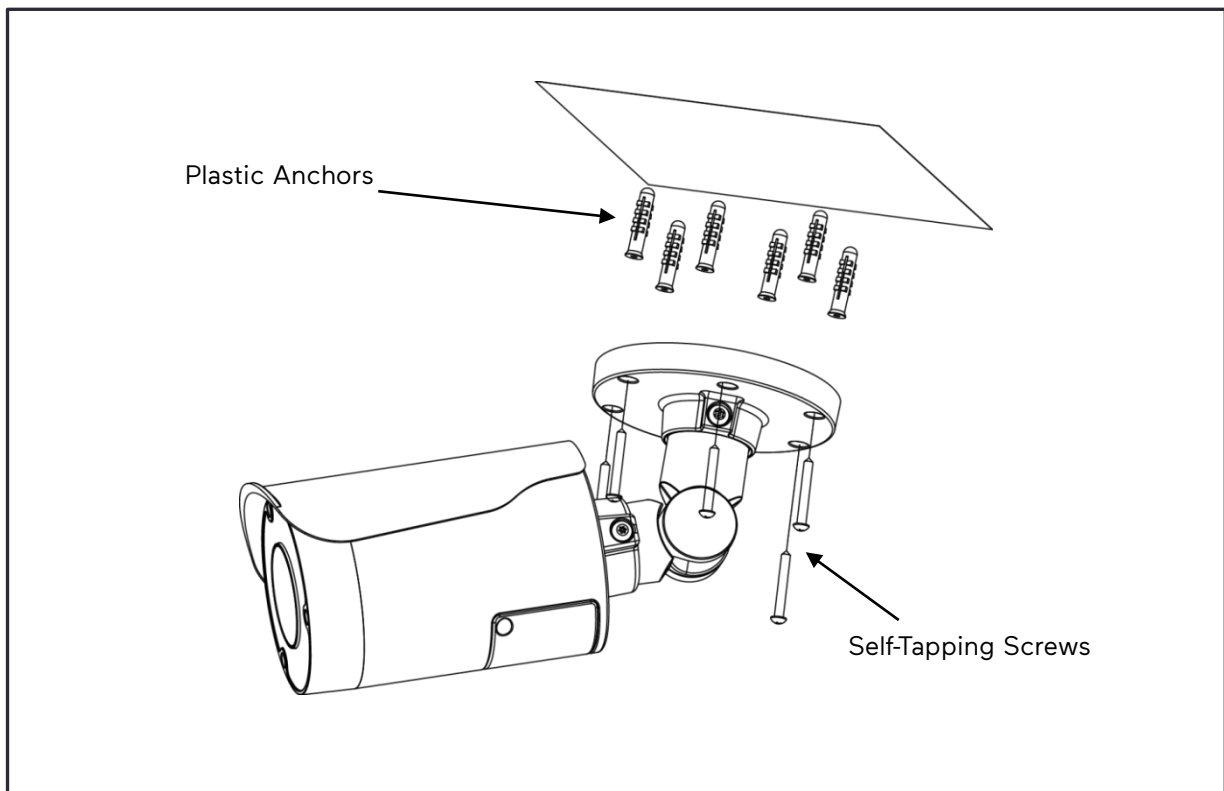

FIGURE 2-4: MOUNTING THE CAMERA

ADJUSTING THE CAMERA POSITION

- **Pan Adjustment (A):** Loosen the locking screw using the T10 torx wrench and rotate the A joint to adjust the camera horizontally.
- **Tilt Adjustment (B):** Loosen the locking screw using the T10 torx wrench and rotate the B joint to adjust the camera vertically.
- **Rotation Adjustment (C):** Loosen the locking screw using the T10 torx wrench and rotate the camera body (C) to adjust the camera position.

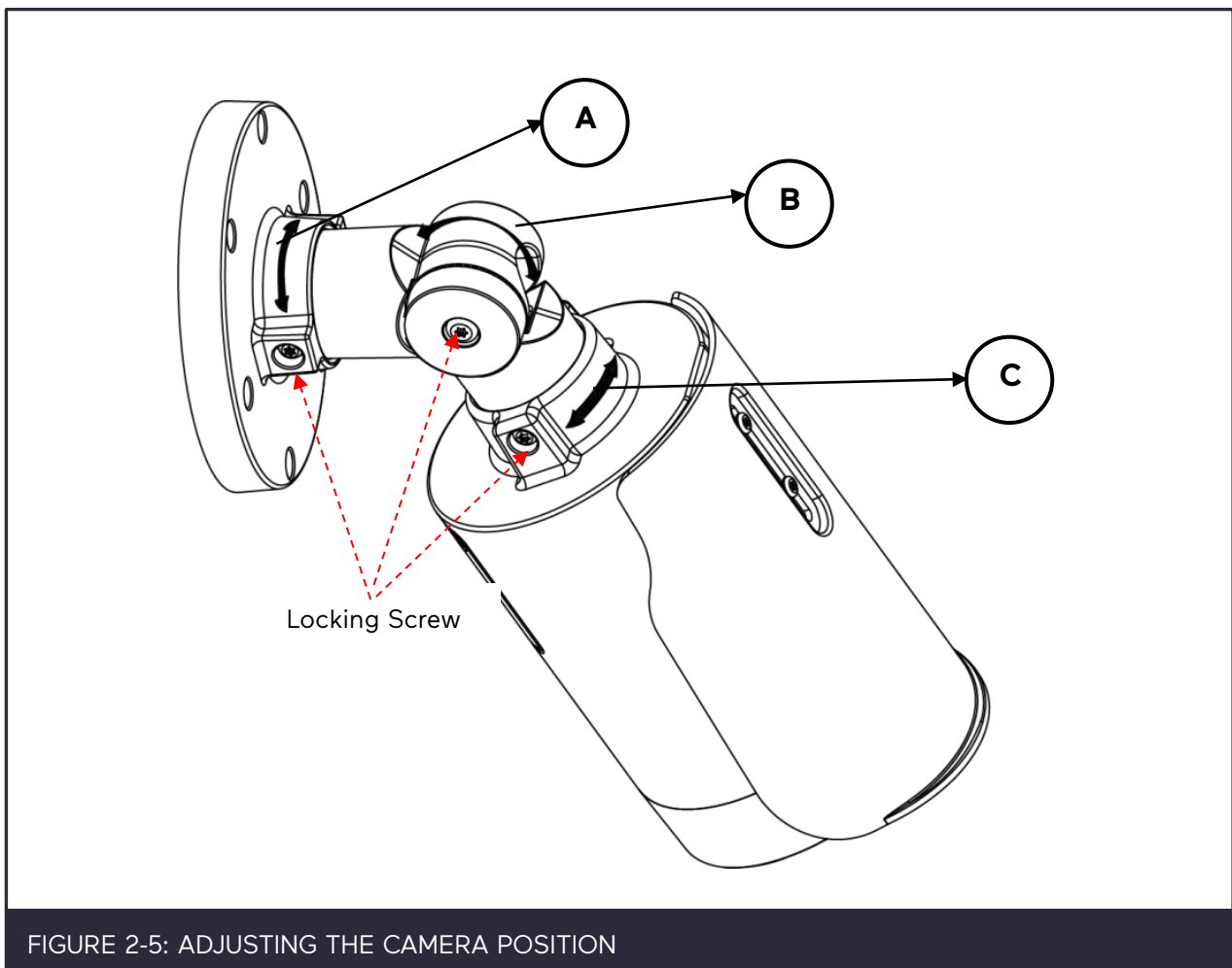

FIGURE 2-5: ADJUSTING THE CAMERA POSITION

CAUTION: Limitation for three axes position:

- Pan range: $\pm 360^\circ$
- Tilt range: $0^\circ \sim 90^\circ$
- Rotation range: ± 360

NOTE: After adjustments, make sure to tighten each joint to prevent the camera from moving.

ADJUSTING THE SUNSHIELD

The sunshield is attached to the camera to minimize the impact from the effects of sun, rain, etc. To adjust the sunshield:

1. Loosen the 2 screws at the top of the sunshield.
2. Move the sunshield forward or backward to the desired position based on the application and then re-tighten the screws.

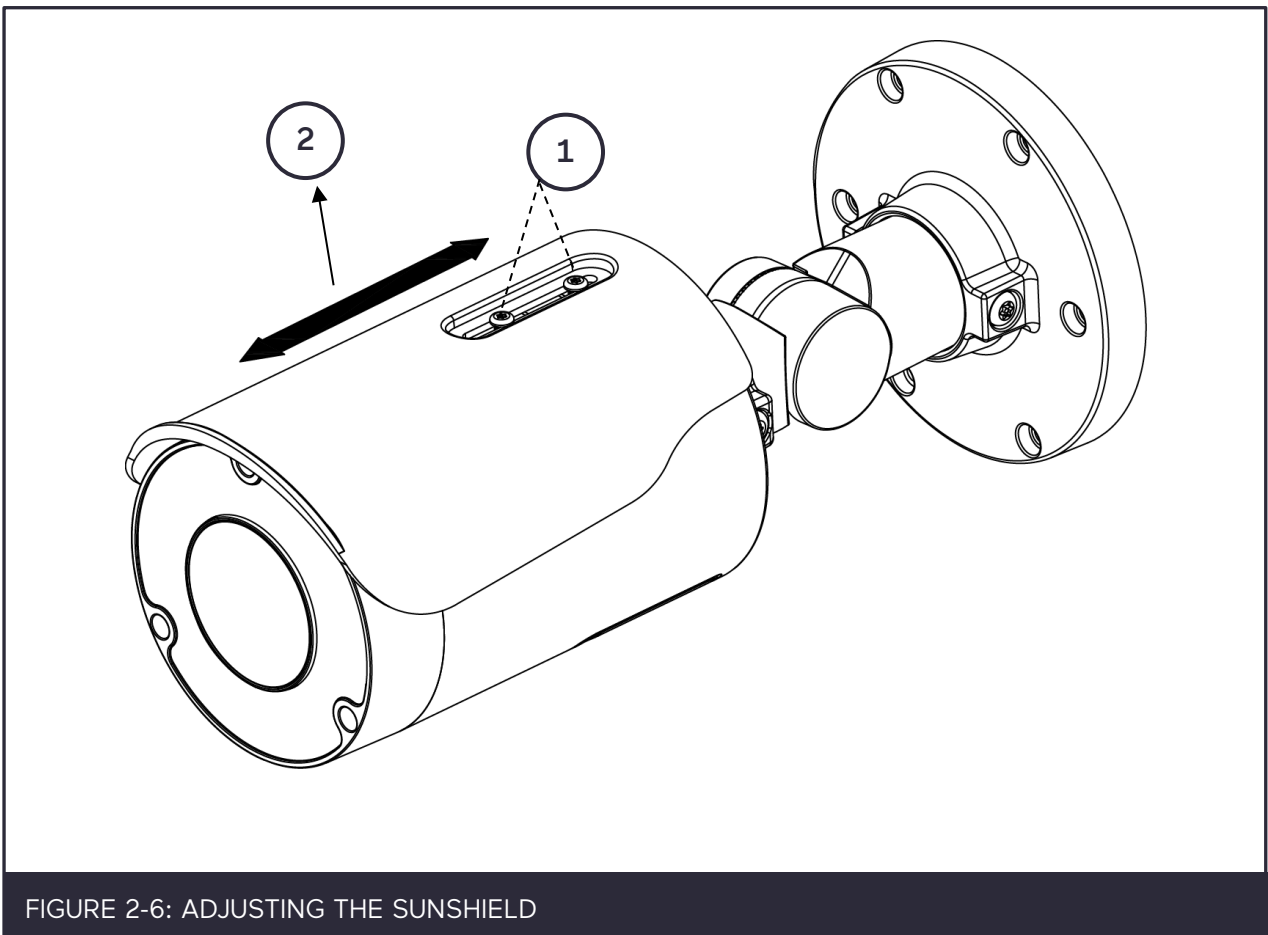

FIGURE 2-6: ADJUSTING THE SUNSHIELD



Vicon Industries Inc. does not warrant that the functions contained in this equipment will meet your requirements or that the operation will be entirely error free or perform precisely as described in the documentation. This system has not been designed to be used in life-critical situations and must not be used for this purpose.

Document Number: 8009-8338-20-00 Rev: 7/24
Product specifications subject to change without notice
Copyright © 2024 Vicon Industries Inc. All rights reserved.

24-Hour Technical Support:
800-34-VICON (800-348-4266)
UK: 44/(0) 1489-566300
Toll Free: 800-645-9116

T: 631-952-2288
F: 631-951-2288

vicon-security.com