

Quick Install Guide

# ANAVIO Dome Cameras

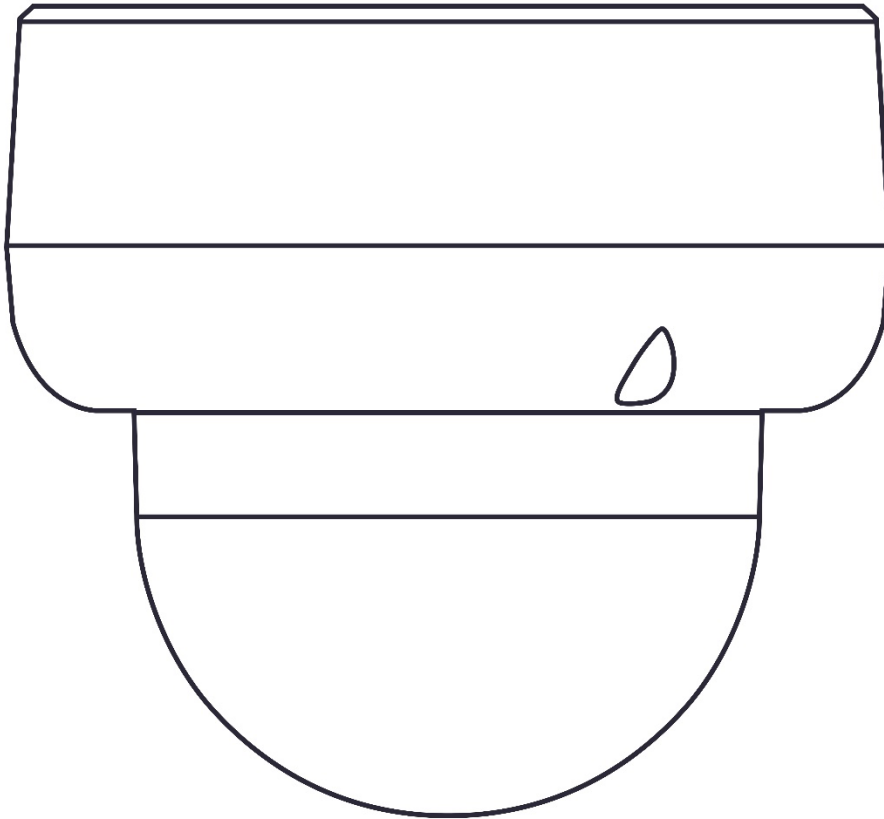

VA-DVF05A-512

VA-DVF08A-1TB



# WARNING

- This camera operates at 12 VDC/24 VAC/PoE (IEEE 802.3af Class 3).
- Installation and service should be performed only by qualified and experienced technicians and comply with all local codes and rules to maintain your warranty.
- We are NOT liable of any damage arising either directly or indirectly from inappropriate installation which is not depicted within this documentation.
- To reduce the risk of fire or electric shock, do not expose the product to rain or moisture.
- Wipe the camera with a dry soft cloth. For tough stains, slightly apply a diluted neutral detergent and wipe with a dry soft cloth.
- Do not apply benzene or thinner to the camera, which may cause the surface to melt or lens to fog.
- Avoid aligning the lens with extremely bright objects (e.g., light fixtures) for long periods of time.
- Although this camera is waterproof and suitable for both indoor and outdoor usages, please do not immerse the camera into water.
- Avoid operating or storing the camera in the following locations:
  - Extremely humid, dusty, or hot/cold environments (recommended operating temperature: -40 to 140° F/-40°C to +60°C)
  - Close to sources of powerful radio or TV transmitters
  - Close to fluorescent lamps or objects with reflections
  - Under unstable or flickering light sources

 <b>CAUTION</b> RISK OF ELECTRIC SHOCK DO NOT OPEN		THIS SYMBOL INDICATES THAT DANGEROUS VOLTAGE CONSTITUTING A RISK OF ELECTRIC SHOCK IS PRESENT WITHIN THE UNIT.
CAUTION: TO REDUCE THE RISK OF ELECTRIC SHOCK, DO NOT REMOVE THE COVER. NO USER-SERVICEABLE PARTS INSIDE. REFER SERVICING TO QUALIFIED SERVICE PERSONNEL.		THIS SYMBOL INDICATES THAT IMPORTANT OPERATING AND MAINTENANCE INSTRUCTIONS ACCOMPANY THIS UNIT.



**WEEE (Waste Electrical and Electronic Equipment).** Correct disposal of this product (applicable in the European Union and other European countries with separate collection systems). This product should be disposed of, at the end of its useful life, as per applicable local laws, regulations, and procedures.

# FCC COMPLIANCE STATEMENT

Information to the user: This unit has been tested and found to comply with the limits for a Class A digital device pursuant to Part 15 of the FCC Rules. Operation is subject to the following two conditions: (1) this device may not cause harmful interference, and (2) this device must accept any interference received, including interference that may cause undesired operation. These limits are designed to provide reasonable protection against harmful interference in a residential installation. This unit generates, uses, and can radiate radio frequency energy and, if not installed and used in accordance with the manual, may cause harmful interference to radio communications. However, there is no guarantee that interference will not occur in a particular installation.

**If this unit does cause harmful interference to radio or television reception, which can be determined by turning the unit off and on, the user is encouraged to try to correct the interference by one or more of the following measures:**

- Reorient or relocate the receiving antenna.
- Increase the separation between the unit and receiver.
- Connect the unit to an outlet on a circuit different from that to which the receiver is connected.
- Consult the dealer or an experienced radio/TV technician for help.

---

**CAUTION** Changes or modifications not expressly approved by the party responsible for compliance could void the user's authority to operate the unit.

---

## CE STATEMENT

Operation is subject to the following two conditions: (1) this device may not cause harmful interference, and (2) this device must accept any interference received, including interference that may cause undesired operation. The manufacturer declares that the unit supplied with this guide is compliant with the essential protection requirements of EMC directive and General Product Safety Directive GPSD conforming to requirements of standards EN55022 for emission and EN 50130-4 for immunity.

This product is IP67 rated for outdoor environments and IK10 rated for impact protection. The camera also product meets regulations required to be NDAA, GSA schedule and TAA approved.

# TABLE OF CONTENTS

<b>1. PRODUCT OVERVIEW</b>	<b>4</b>
<hr/>	
<b>PHYSICAL CHARACTERISTICS</b>	<b>4</b>
<b>2. INSTALLATION AND MOUNTING</b>	<b>9</b>
<hr/>	
<b>PACKAGE CONTENTS</b>	<b>9</b>
<b>INSTALLATION</b>	<b>9</b>
CHECKING APPEARANCE	10
DISASSEMBLING THE CAMERA	10
INSTALLING THE DESICCANT	11
CONNECTING THE CABLES	12
MOUNTING THE CAMERA	14
POSITIONING THE CAMERA	16
REASSEMBLING THE CAMERA	17
LOWER DOME DEFOG	18

# 1. PRODUCT OVERVIEW

## PHYSICAL CHARACTERISTICS

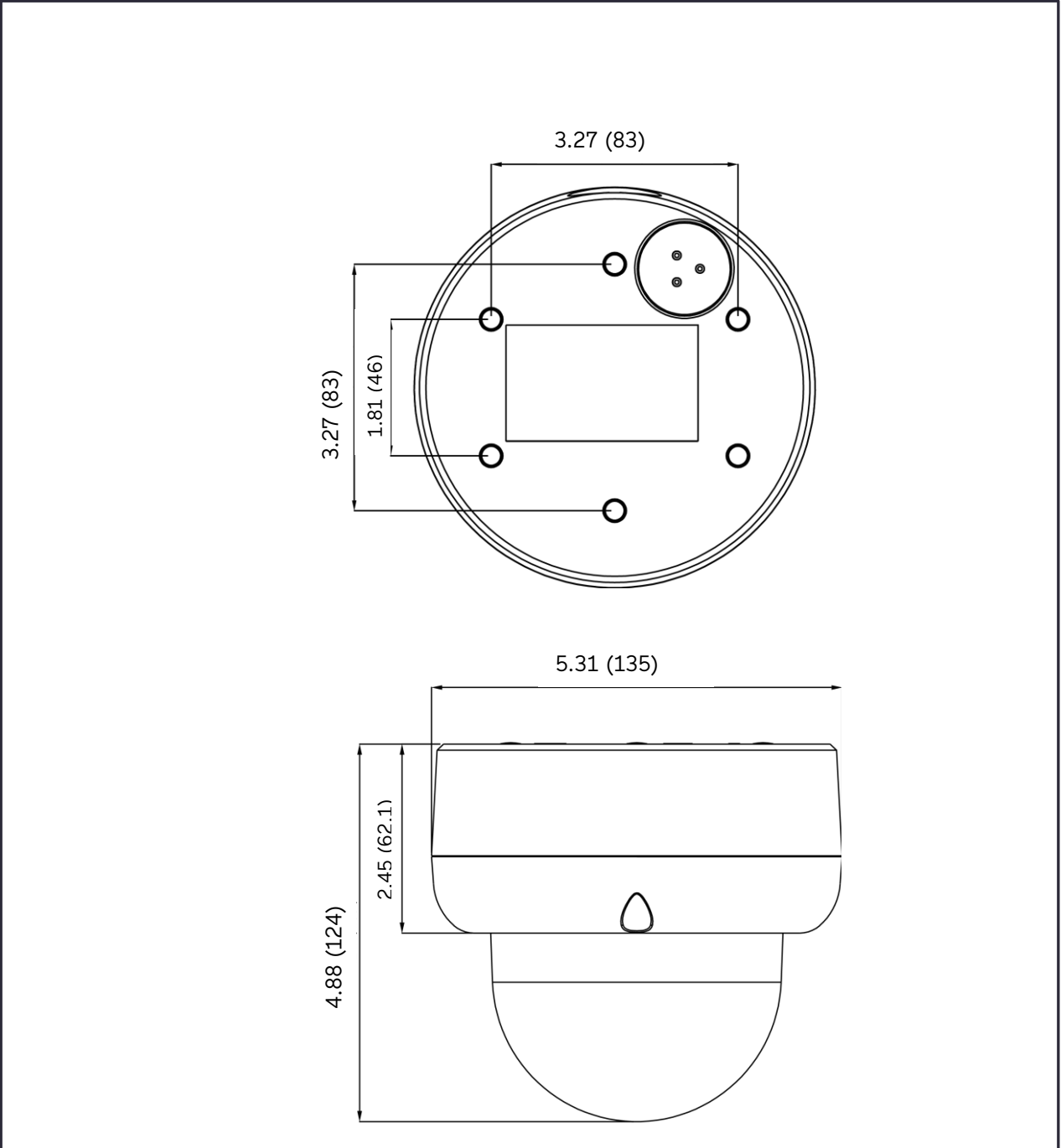

FIGURE 1-1: PHYSICAL DIMENSIONS [IN. (MM)]

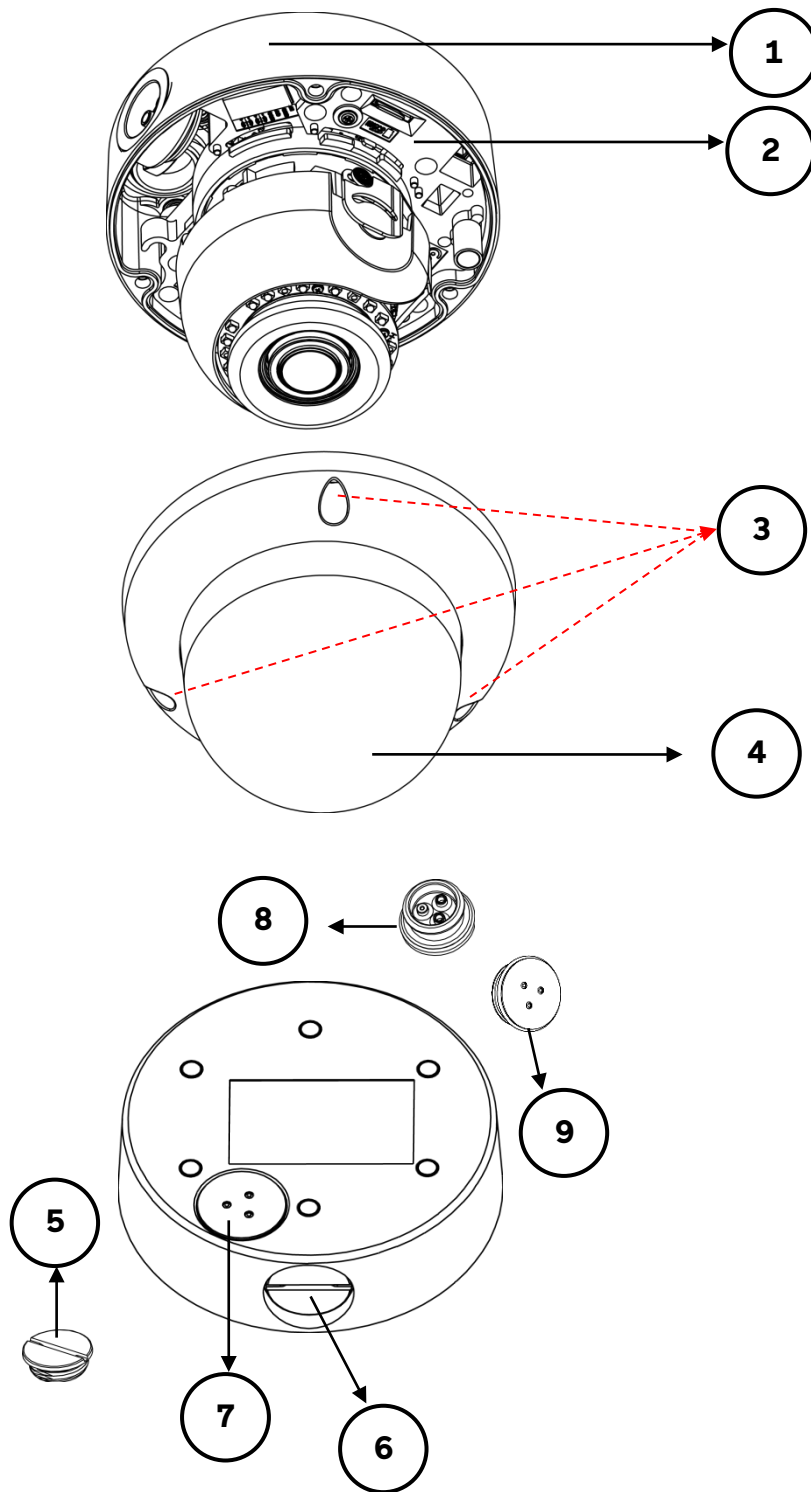

FIGURE 1-2: PARTS

1

**Camera Base**

Base of the dome camera.

2

**Camera Module**

The physical main body of the camera.

3

**Camera Cover Screws**

Screws (3X) for affixing the camera cover to the camera base.

4

**Camera Cover**

The top cover of the housing.

5

**Conduit Hole Plug**

To close the unused conduit hole (delivered pre-installed).

6

**Side Conduit Hole**

The side hole for cable entry.

7

**Bottom Conduit Hole**

The bottom hole for cable entry.

8

**Black Conduit Hole Rubber Grommet**

For water and dust ingress protection; *must* be used when the cables are run directly into the Side Conduit Hole to prevent water leakage issue. Use plug 5 on the bottom hole.

9

**Gray Conduit Hole Rubber Grommet**

For water and dust ingress protection; *must* be used when the cables are run directly into the Bottom Conduit Hole to prevent water leakage issue. Use plug 5 on the side hole.

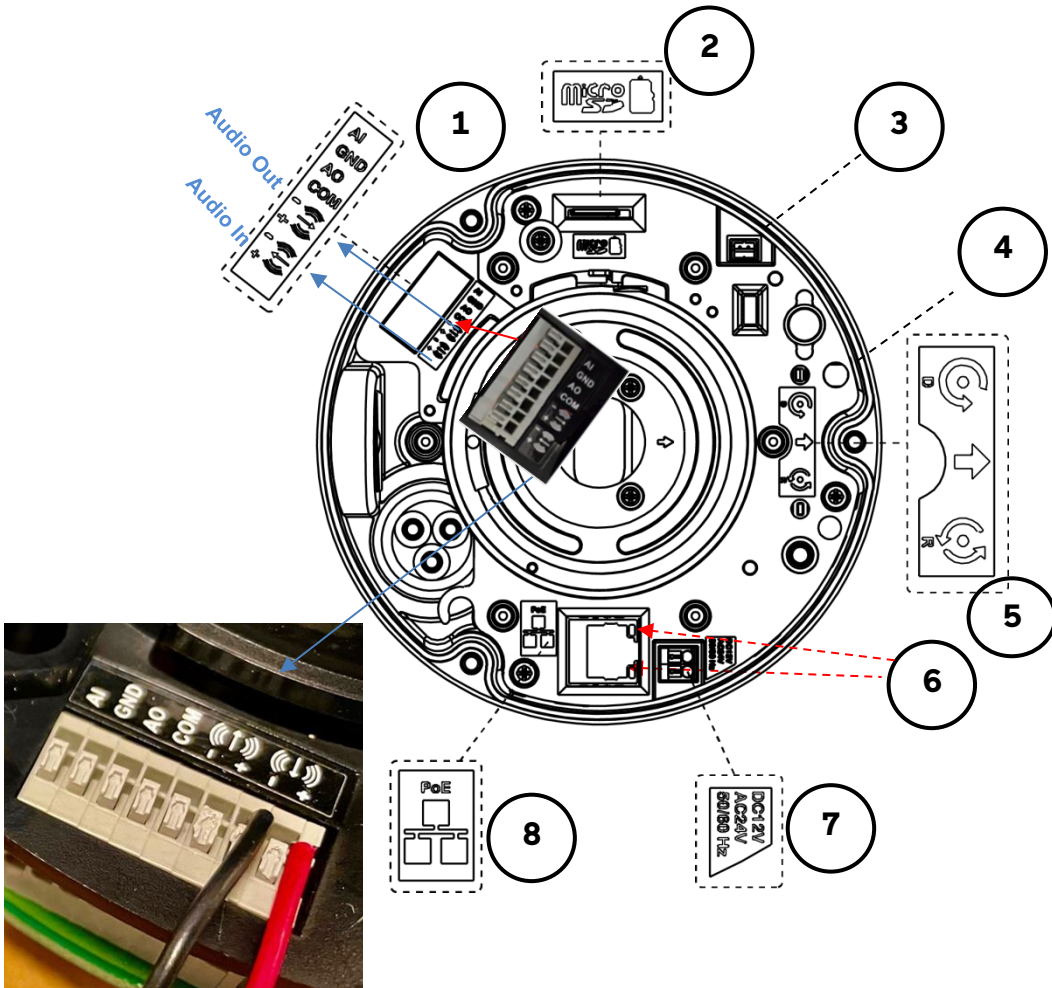

Typical Audio Input Wiring

FIGURE 1-3: CAMERA INTERFACES





1

## Alarm/Audio Inputs and Outputs

DI/DO (Digital Input/Digital Output) ports are provided for external devices, e.g., door contacts, smoke detector, audible alarm, etc.

- Alarm In: Via "AI" and "GND" ports; connect to external device that can trigger alarm input signals.
- Alarm Out: Via "AO" and "COM" ports; connect to external device to be triggered through alarm output signals.

Audio Input/Output ports are provided for connection of external microphone and speaker.

- Audio In: Via "+" and  ports; connect to external device, such as microphone.
- Audio Out: Via "+" and  ports; connect to device, such as speaker.

2

## Micro SD Card Slot

Micro-SD card slot for recording and file storage.

Micro SD card 512 GB/1 TB, included.

3

## Video Output

For analog video output.

4

## Status LEDs

Solid Red: Indicates boot up is running.

After 2-3 seconds:

- Solid Red to Flashing Green if boot up is normal.
- Remains Solid Red if an error occurs.
- Turns off 3 minutes after a successful boot.

Flashing Amber: Indicates firmware upgrade is running.

5

## Default and Reset Button

Press the D button for 6 seconds to restore the camera settings to factory default.

Press the R button for less than 1 second to reboot the camera.

6

## Network LED Indicators

Solid Green: Indicates a live connection is established.

Flashing Orange: Indicates data is being transmitted/received between the camera and the network.

7

## Power Terminal

The port is used to connect with external power supply, either 12 VDC or 24 VAC.

8

## RJ-45 Network Port

Connect the RJ-45 connector to this port with a PoE (Class 3) compatible network device that supplies power through the Ethernet cable.

## 2. INSTALLATION AND MOUNTING

### PACKAGE CONTENTS

Ensure all items listed below are included in the packing box.

- Dome Camera (Qty 1)
- Plastic Anchor (Qty 4)
- Pan Head Screw (TP4) (Qty 4)
- T20 Security Torx Bit (Qty 1)
- Mounting Template (Qty 1)
- Conduit Hole Rubber Grommet (Qty 2)
- Conduit Hole Plug Cover (Qty 1)
- RJ-45 Jumper Cable and Waterproof Tape (Qty 1 of each)
- Video Out BNC Cable (Qty 1)
- Desiccant (Qty 1)

### INSTALLATION

The following tools might be helpful for completing the installation:

- Drill
- Screwdrivers
- Wire cutters

## CHECKING APPEARANCE

When unpacking, check to see if there is any visible damage to the appearance of the camera and its accessories. Remove the protective materials from the camera after every item is properly checked in accordance with the list in **Package Contents**.

## DISASSEMBLING THE CAMERA

1. Use the T20 security Torx bit to loosen the 2 screws on the camera cover.
2. Gently pull the camera cover downward to separate it from the camera body. DO NOT remove the camera from the camera base during installation. The camera has been designed to allow installation without removing the camera module from the back box.

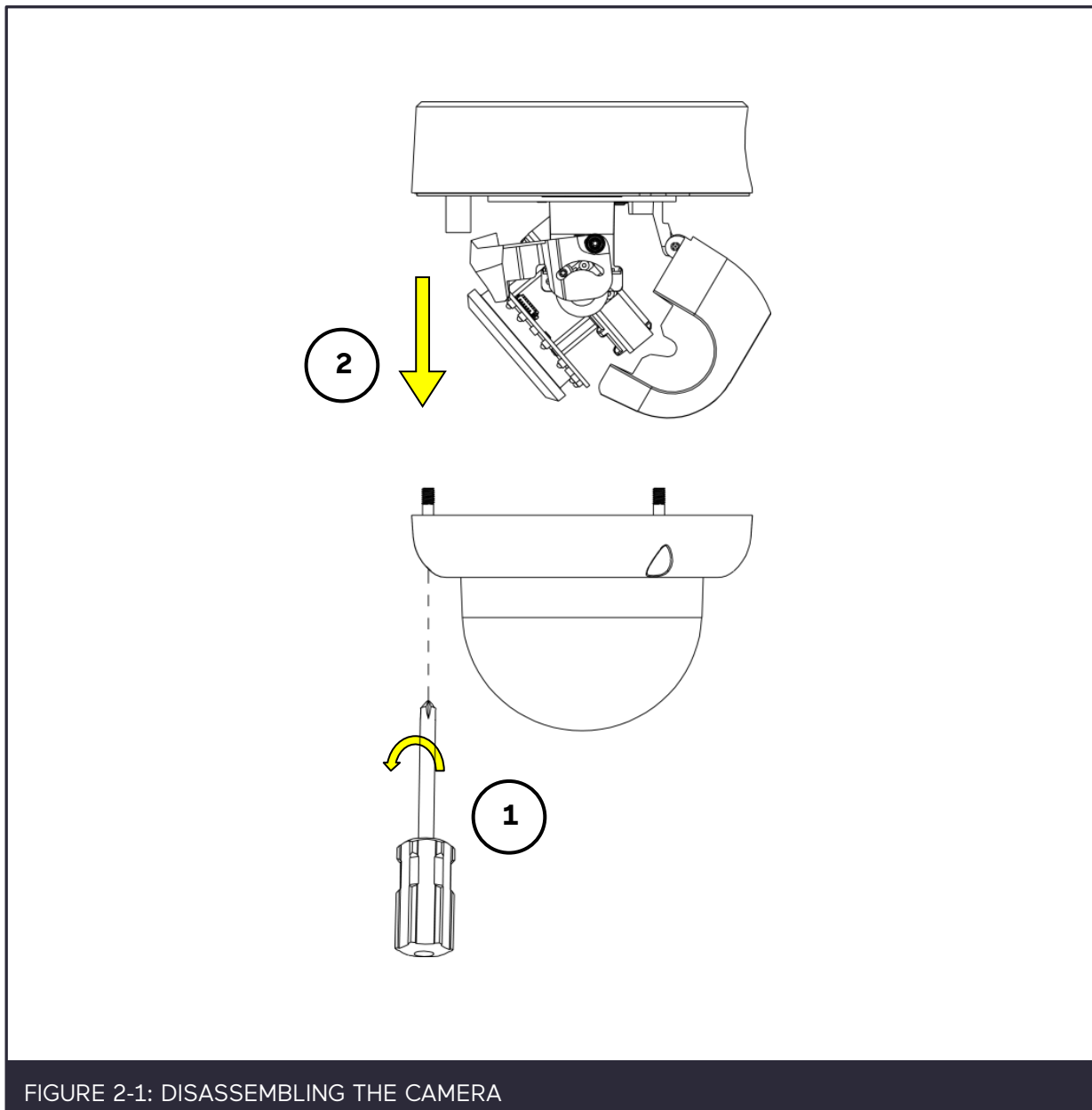

FIGURE 2-1: DISASSEMBLING THE CAMERA

## INSTALLING THE DESICCANT

1. Lift to open the shroud.
2. Secure the desiccant (via the sticker that is attached to the desiccant) on the inside part of the shroud as shown in the following figure.

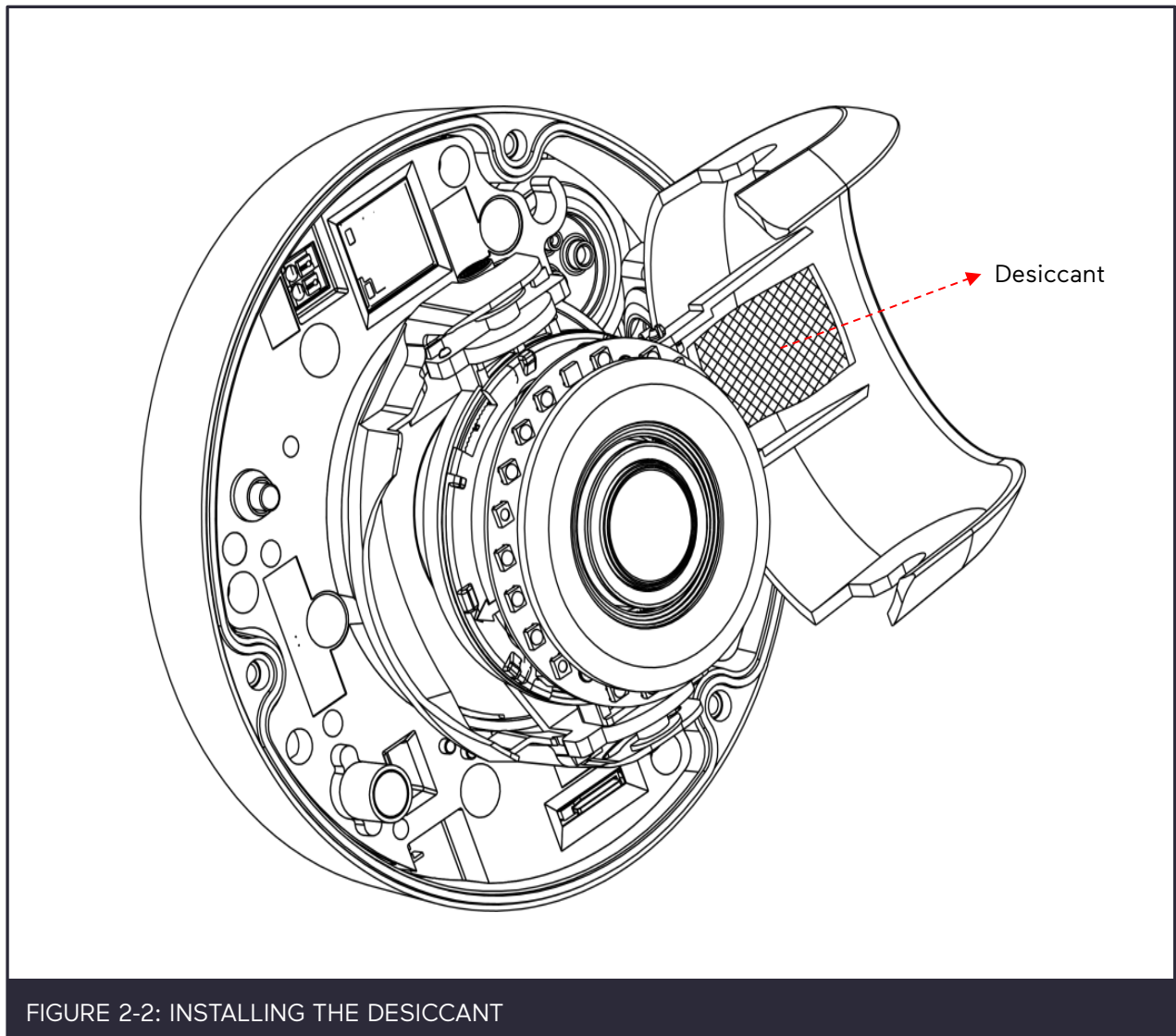

FIGURE 2-2: INSTALLING THE DESICCANT

3. Return the shroud back to its default position after desiccant installation.

## CONNECTING THE CABLES

The I/O interfaces are on the front of the camera module. Make the appropriate cable connections.

1. Based on your needs, connect the power cable to the power port via one of the following 3 options.
  - **24 VAC:** Connect a power cable that supplies 24 VAC power source to the power terminal.
  - **12 VDC:** Connect a power cable that supplies 12 VDC power source to the power terminal.  
**NOTE:** Be sure the polarities match when using 12 VDC power source.
  - **PoE (Class 3):** Connect an Ethernet cable terminated with a short-bodied RJ-45 connector to the PoE RJ-45 port for both power supply and network connectivity.  
**NOTE:** For installations using Cat6 cable or pre-terminated cables with rubber jackets, a jumper cable accessory is supplied to provide easy installation for the increased size of the cable; waterproof tape is also included to maintain the watertight integrity of the installation. Refer to the instruction sheet with the jumper cable for details on using it.
2. Connect BNC cable for video output, if required. BNC cable is used to connect to the video input terminal of a monitor, switcher, etc. (to be terminated with 75 ohm impedance). Do NOT pass the BNC cable through the supplied rubber grommet, as that will damage the waterproof protection. Refer to graphic below for how to properly use the supplied grommet.
3. Insert audio in/out cables and alarm in/out cables to the corresponding terminals of the camera if required.  
**NOTE:** It is recommended to connect microphones to ground (GND) on the digital I/O connector. Refer to Figure 1-3 for details on I/O interface.
4. If using the supplied rubber grommet (recommended), puncture a round hole(s) in the grommet that is smaller than the diameter of the cable that will be passed through the grommet. Feed an unterminated cable through the hole in the grommet. Terminate the cable with the appropriate connector.

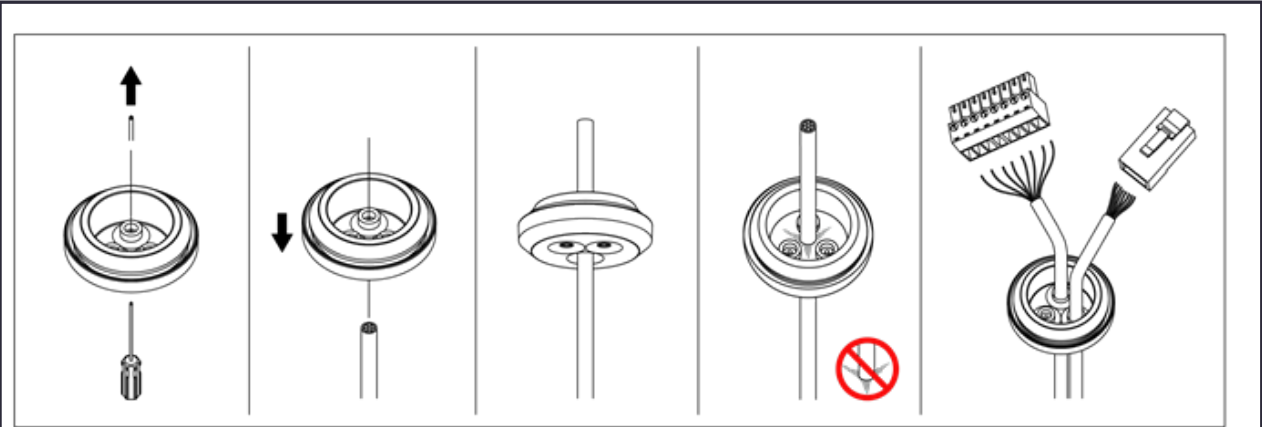

FIGURE 2-3: USING RUBBER GROMMET

## MOUNTING THE CAMERA

1. Place the supplied mounting template on a mounting surface. Drill 6 mm (0.2") outer holes at the T1 (double gang box) or T2 (single gang box) template positions on the mounting surface.
2. Insert 2 or 4 supplied plastic anchors into the holes.
3. If feeding wiring from the hole on the rear of the camera bottom case, create a circular opening corresponding to the bottom conduit hole on the mounting template on the mounting surface.
4. If feeding wiring from the side of the camera bottom case, it is not necessary to drill a hole on the mounting surface. The side conduit hole on the mounting template is for user to identify orientation while mounting.

**NOTE:** Properly close the unused conduit hole with the supplied conduit hole plug. For example, block the side conduit hole with the plug when using the bottom conduit hole for cable entry and vice versa.

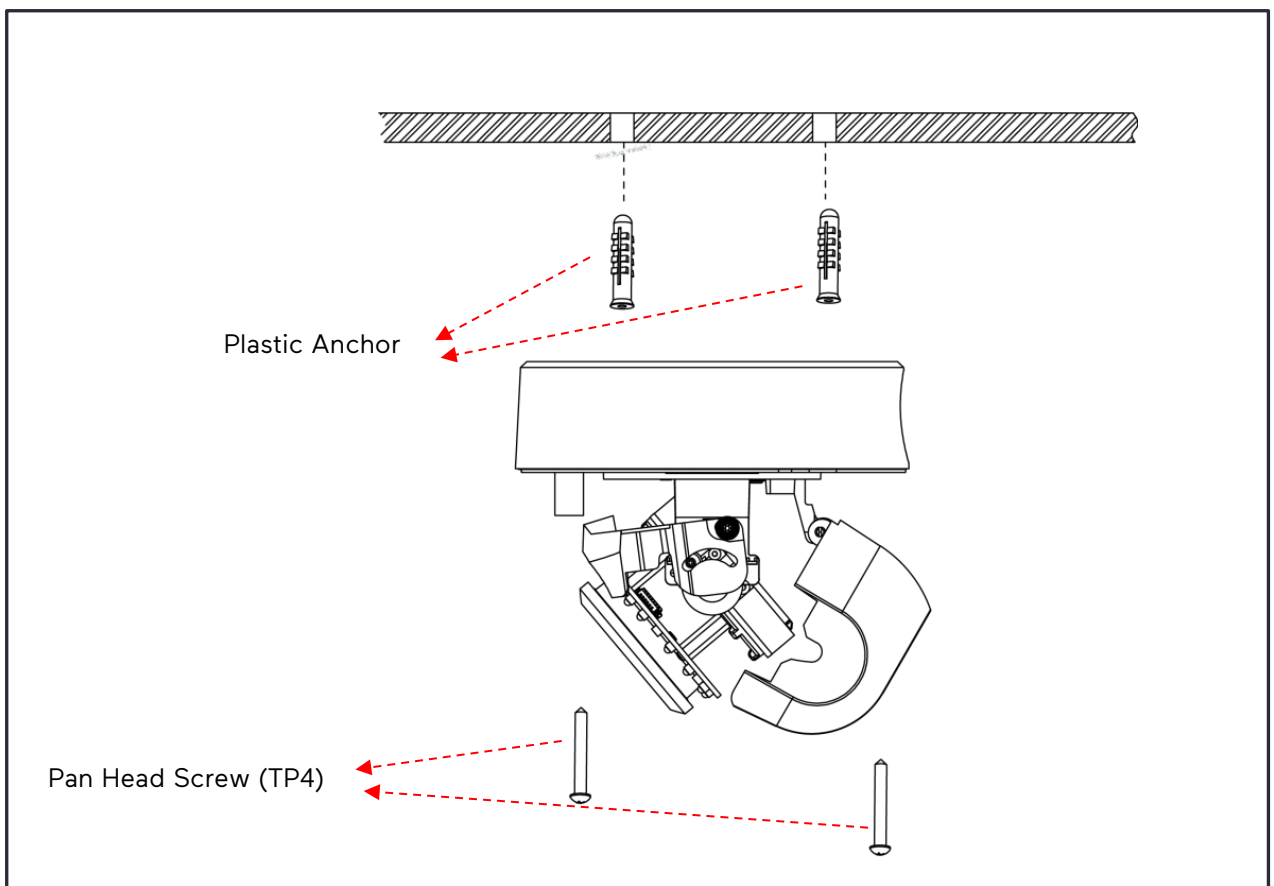

FIGURE 2-4: WALL OR CEILING SURFACE MOUNT

5. Based on your installation requirements, use the bottom or side conduit hole on the camera base for cable entry and feed the cables through the camera base first. Then mount the camera base on a wall surface by tightly securing 4 TP4 screws (supplied) into the inserted plastic anchors.

**NOTE:** If you are mounting directly to a flat surface, remove the rubber plugs. Otherwise, do NOT remove the small black plugs from the mounting hole; this maintains the waterproof protection.

Alternatively, the camera base can be fastened directly to a single gang or double gang electrical box (fasteners not provided).



## POSITIONING THE CAMERA

- **Pan Adjustment (A):** Rotate the lens camera assembly to the desired field-of-view. Note that the camera lens should not be rotated further than the point where the side conduit hole of the camera base is located.
- **Horizontal Rotation (B):** Rotate the lens camera assembly in the camera module; do not turn assembly more than 355°, which can cause the internal cables to be twisted, disconnected or broken. In addition, pay attention to the location of the light sensor (1) since excessive rotation can result in obstruction to light sensor by the IR reflection shield (2).
- **Tilt Adjustment (C):** Lift to open the shroud and tilt the camera lens to the desired angle. Restore the shroud back to its default position after adjustment.

**CAUTION:** Limitation for three axes position:

Pan range: 0° ~ 370°

Rotation range: 0° ~ 355°

Tilt range: 15° ~ 90°

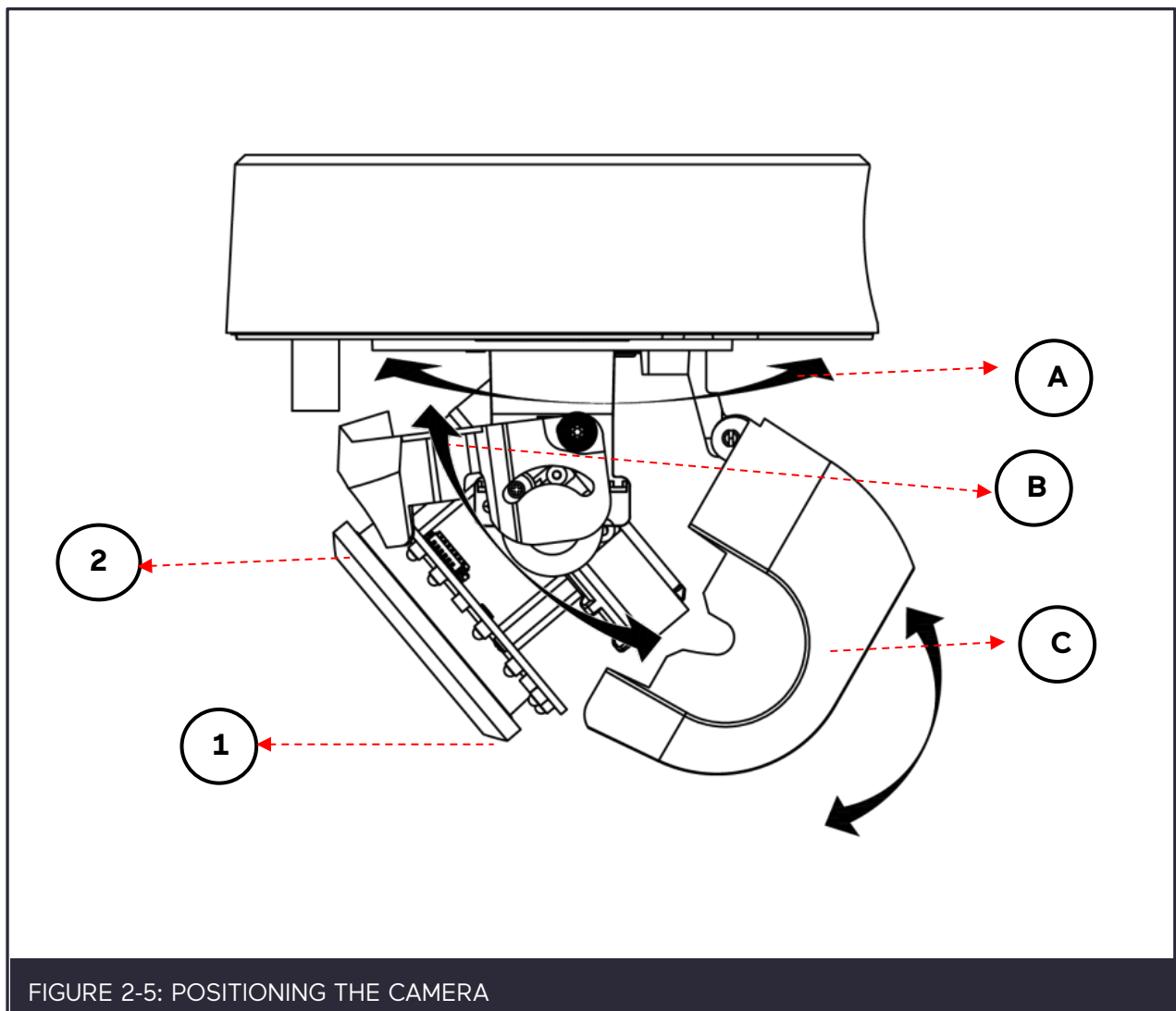

FIGURE 2-5: POSITIONING THE CAMERA

## REASSEMBLING THE CAMERA

Assemble the camera cover with the camera base, both of which have red dots for indicating alignment; then fasten the 3 screws of the lower dome with the T20 security torx bit to complete the installation.

**NOTE:** To avoid moving the tilt position, take care to angle the camera cover below the camera module when installing it.

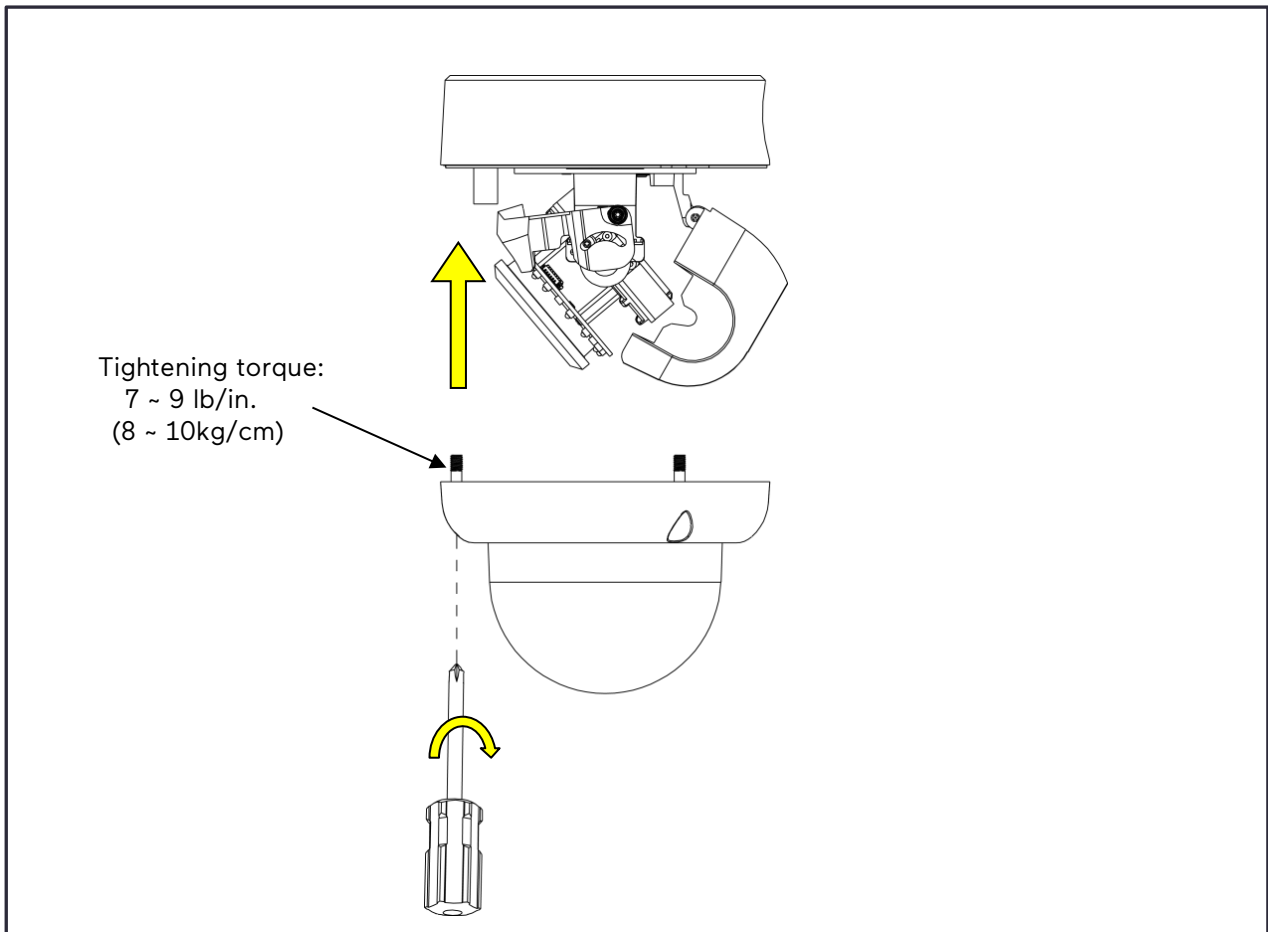

FIGURE 2-6: ASSEMBLING AND COMPLETING CAMERA MOUNTING

## CAMERA COVER DEFOG

A Defog function, which heats up the camera to overcome certain extreme weather conditions (e.g., snow or frost) that may harm the operation of camera, is embedded within this camera. This defog heater ring is on between 140° to -40° F (60° to -40° C). To prevent installers from getting a burn injury, the defog heating function is not activated when the camera cover is detached from the camera module (as shown in the following figure).

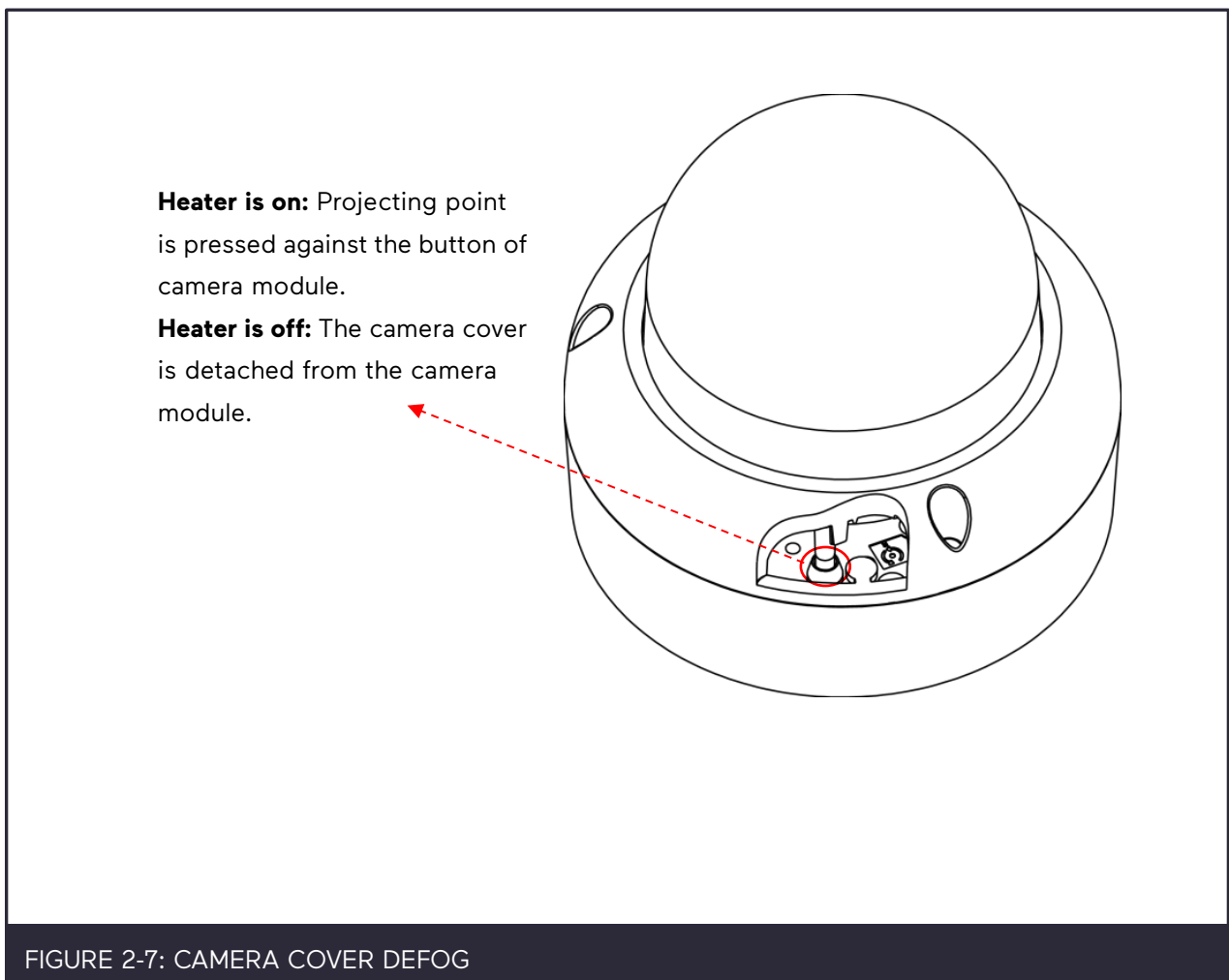

FIGURE 2-7: CAMERA COVER DEFOG



Vicon Industries Inc. does not warrant that the functions contained in this equipment will meet your requirements or that the operation will be entirely error free or perform precisely as described in the documentation. This system has not been designed to be used in life-critical situations and must not be used for this purpose.

Document Number: 8009-8336-20-00 Rev: 7/24  
Product specifications subject to change without notice  
Copyright © 2024 Vicon Industries Inc. All rights reserved.

24-Hour Technical Support:  
800-34-VICON (800-348-4266)  
UK: 44/(0) 1489-566300  
Toll Free: 800-645-9116

T: 631-952-2288  
F: 631-951-2288

[vicon-security.com](http://vicon-security.com)